

2016–2017 SPORTSMAN 570 TOURING, X2, 6X6, AND UTE HEAT MANAGEMENT KIT



P/N 2207446

APPLICATION

2016–2017 Sportsman 570 Touring, X2, 6x6, and UTE Models

BEFORE YOU BEGIN

Read these instructions and check to be sure all parts and tools are accounted for. If you are working with a printed copy please ensure you have the latest version.

KIT CONTENTS

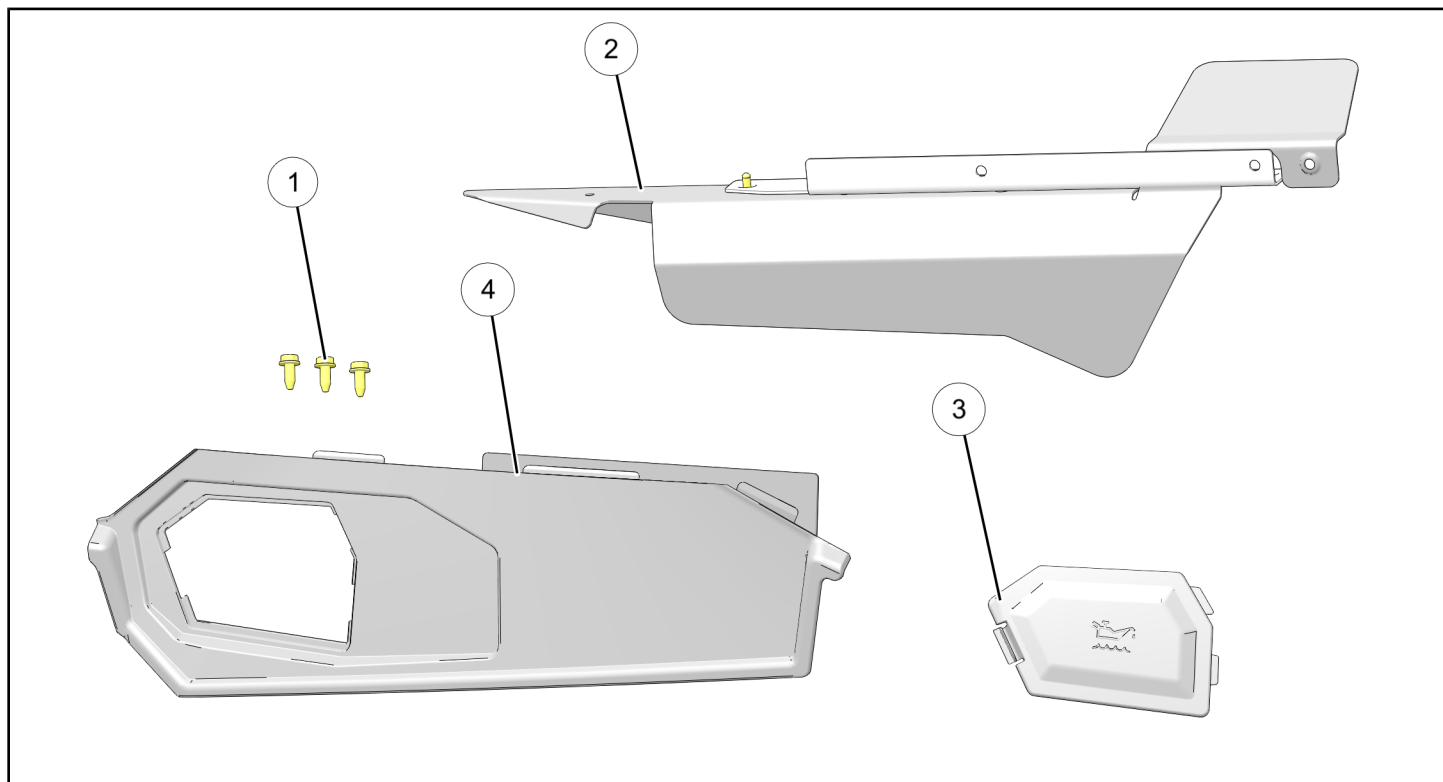

REF	QTY	PART DESCRIPTION	PART NUMBER
1	3	Screws	7517386
2	1	ASM - Shield, Airbox	2636957
2	1	Panel Access- RH	2637041-070
3	1	ASM - Close Off/Shield, RH, Basic	2636956-070
–	1	Kit Instruction Card	9928589

TOOLS REQUIRED

- Safety Glasses
- 3/8 inch (10 mm) socket
- Multi-Function Pliers
- Ratchet

IMPORTANT

The 2016–2017 Sportsman 570 Touring, X2, 6x6, and UTE Heat Management Kit is exclusively designed for vehicles affected by this Service Advisory. Please read the installation instructions thoroughly before beginning. Installation is easier if the vehicle is clean and free of debris. For your safety, and to ensure a satisfactory installation, perform all installation steps correctly in the sequence shown.

INSTALLATION INSTRUCTIONS

HEAT SHIELD INSTALLATION

1. Place the vehicle in park. Turn the vehicle off, and remove the key from the ignition.
2. Remove the seat.
3. Remove the two Tuflok rivets ① retaining the rear of the right side panel.

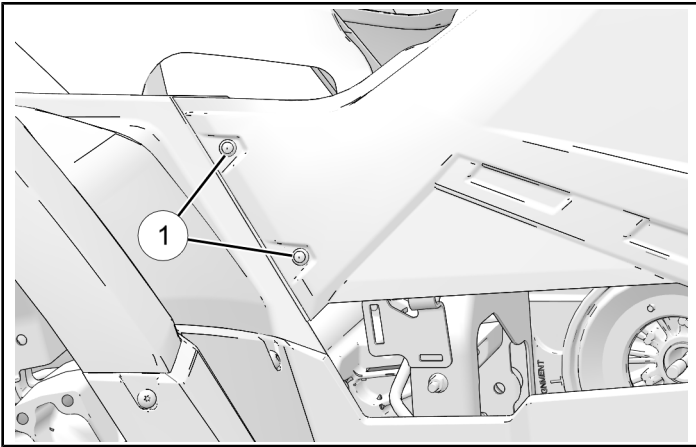

4. Remove the right rear side panel.

WARNING

Allow vehicle to cool before servicing heat shields.

5. If an existing air box shield is present, remove the three 3/8 inch (10 mm) fasteners ② and remove the shield. Discard the old shield.

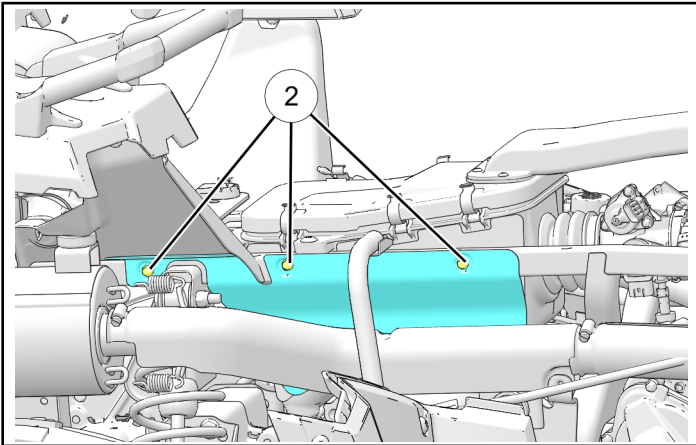

NOTE

The three mounting holes in the new air box shield align with the holes for the old air box shield. If the mounting holes are not present they will need to be drilled for the new heat shield.

6. If the mounting holes are not present, refer to the Service Manual for Rear Cab Removal and remove the Rear Cab. If the mounting holes are present, proceed to step 9.

7. Guide the new heat shield (P/N 2636957) over the exhaust pipe and line up with the edge of the shock tower ③ as shown.

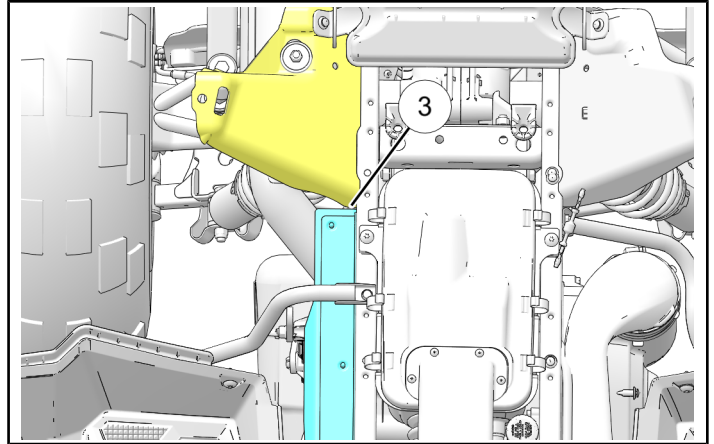

8. Mark the location of the mounting holes ④ in the heat shield with a center punch. Remove the shield and drill the marked mounting holes with a 3/16 inch drill bit.

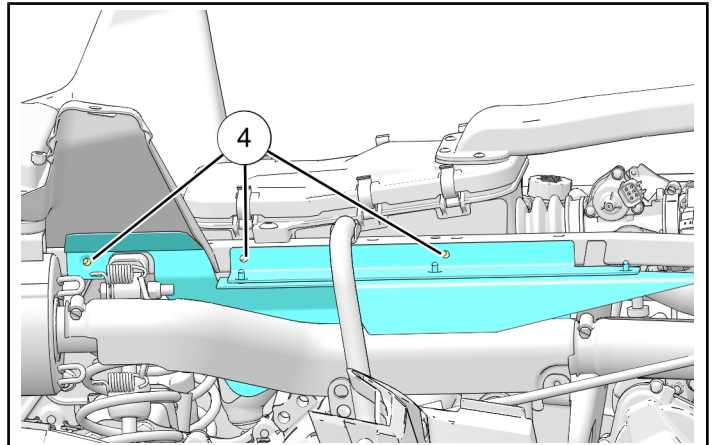

9. Guide the new heat shield (2636957) over the exhaust pipe and line up with the mounting holes.
10. Install the three self tapping 3/8 inch (10 mm) heat shield retaining bolts ⑤ (P/N 7517386) into the existing holes on the frame. Torque until fully seated.

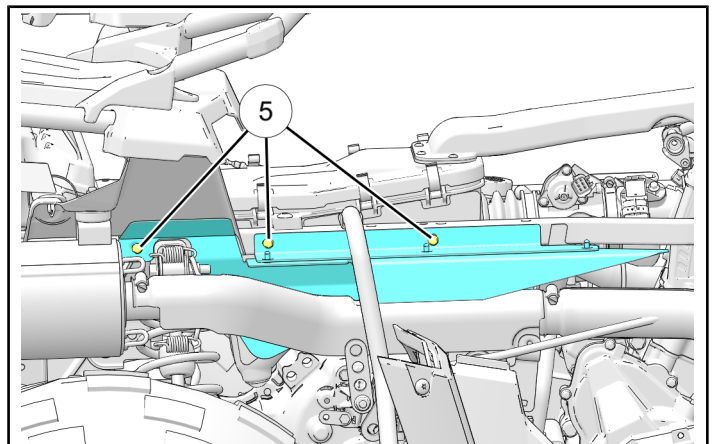

11. Reinstall the Rear Cab per Service Manual Instructions if previously removed.

SIDE PANEL INSTALLATION

1. Install the access panel (P/N 2630741-070) into the close off panel (P/N 2636956-070) by inserting the tabs into the close off panel as shown.

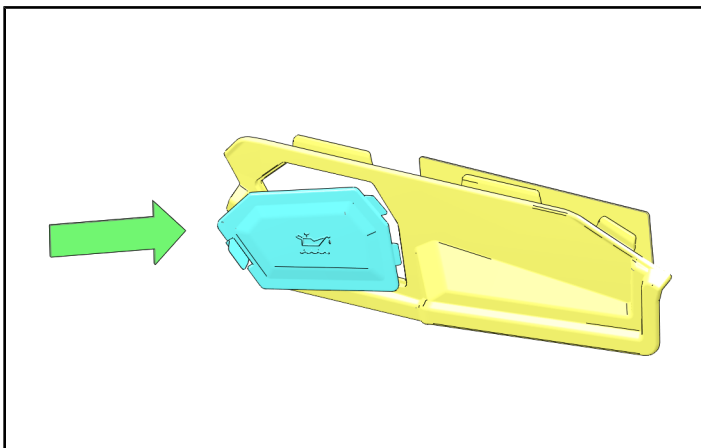

2. Install the new close off panel ⑥ into the right hand foot well as shown.

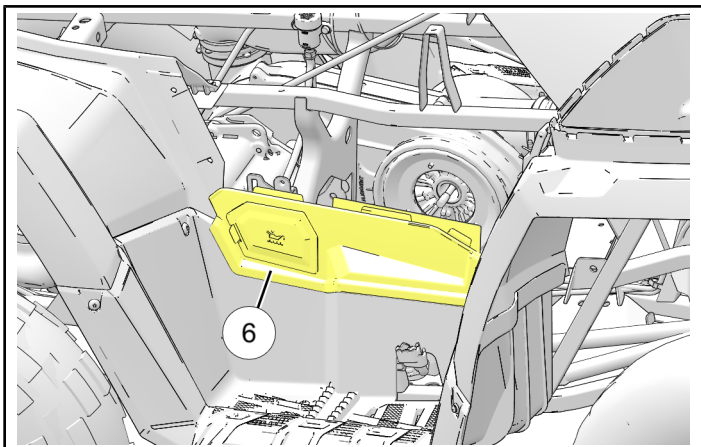

3. Align the close off panel tabs to the bottom of the right side panel, and secure them together as shown.

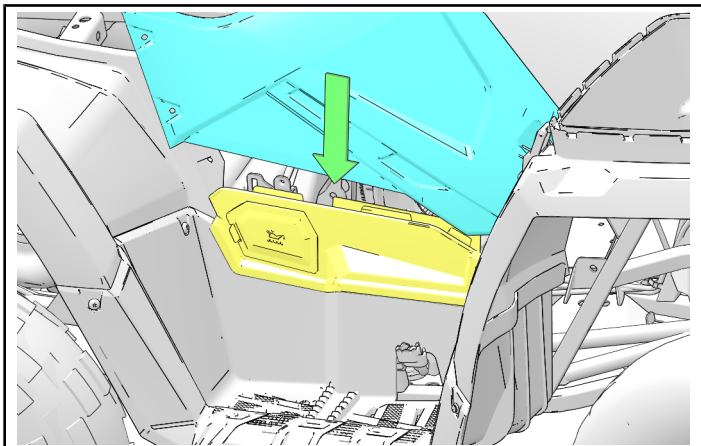

4. Align the right side panel tabs to the front cab, and secure them.

5. Install previously removed Tuflok rivets ⑦ to secure the right side panel to the rear cab.

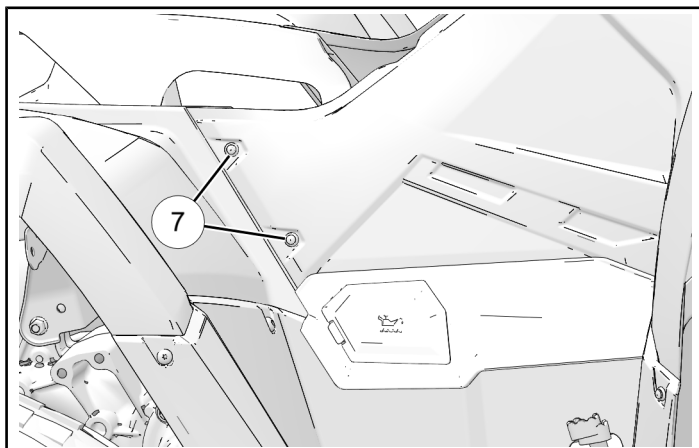

6. Install the seat and ensure proper fit and finish of all associated panels.

FEEDBACK FORM

A feedback form has been created for the installer to provide any comments, questions or concerns about the installation instructions. The form is viewable on mobile devices by scanning the QR code or by clicking [HERE](#) if viewing on a PC.

FEEDBACK FORM

